

# POWERPACK SE SERIES

## 6-10 kVA

**1:1**  
PHASE

ONLINE UPS



HOME/OFFICE



EMERGENCY



MEDICAL



INDUSTRY



DATA CENTER



TRANSPORT



UPS ONLINE



TOWER



POWER FACTOR



SERVICE



### FEATURES

- High Frequency and True Double-Conversion
- DSP (Digital Signal Processors) Technology
- Input Power Factor Correction (PFC)
- Wide Input Voltage Range (110~300V)
- Output Power Factor 0.9
- Cold Start
- Auto Sensing Frequency
- ECO Mode Operation for Energy Saving
- Selectable Output Voltage via LCD
- 50Hz/60Hz Frequency Converter Mode Available
- Selectable Battery Low Voltage via LCD
- Power-On Self Test
- Advanced Battery Management (ABM)
- Short Circuit and Overload Protection
- Automatically Charging Battery at UPS Off Mode
- Fan Speed Auto Control when Load Varies
- Generator Compatible
- Standard RS232 Communication Port
- USB/SNMP Communication Port (Optional)
- Emergency Power Off (EPO) (Optional)
- Extension Battery Bank (Optional)
- Manual Bypass
- N+X Redundancy Parallel (Optional)

### CERTIFICATES



### DETAILS

1. Input-Output Terminal
2. Input Breaker
3. Battery Breaker
4. Maintenance Switch
5. Fan
6. Battery Temperature Sensor
7. Parallel Card (Optional)
8. EPO
9. RS232
10. USB (Optional)
11. SNMP/AS400 (Optional)
12. BAT\_NTC (Optional)

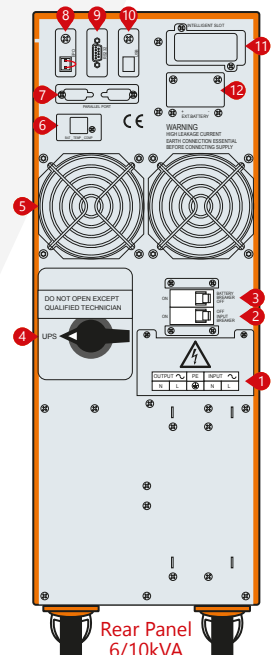

Rear Panel  
6/10kVA

MODEL		6kVA / 5400W	10kVA / 9000W
Power Watt		6kVA / 5400W	10kVA / 9000W
<b>INPUT</b>			
Related Voltage		208V / 220V / 230V / 240 VAC	
Voltage Range		Half Load (110-300) ±5 VAC, Full Load (160-300) ±5 VAC	
Frequency		40 ~ 70 Hz (Auto Sensing)	
Power Factor		≥0.99	
Bypass Voltage Range		160V - Rated Output Voltage +32V	
<b>OUTPUT</b>			
Voltage Range		208V / 220V / 230V / 240 VAC (Setting Available via LCD)	
Voltage Regulation		±1%	
Frequency		45 ~ 55 Hz or 55 ~ 65 Hz (Synchronized Range); 50 / 60 Hz ±0.1 Hz (Battery Mode)	
Waveform		Pure Sine Wave	
Crest Factor		3:1	
Harmonic Distortion		≤2% (Linear Load); ≤5% (Non-Linear Load)	
Transfer Time		AC Mode to Battery Mode: 0ms Inverter Mode to Bypass Mode: 0ms	
Overload Capability		105% ~ 125%: Transfer to Bypass after 3min 125% ~ 150%: Transfer to Bypass after 30sec >150%: Transfer to Bypass after 100ms	
<b>EFFICIENCY</b>			
AC Mode		≥92%	
ECO Mode		≥98%	
<b>BATTERIES</b>			
DC Voltage		192V-240V	
Inbuilt Battery		16-20 x 7-9Ah	
Charge Current	Standard Model	1A	
	Long Time Model	1A / 3.5A / 7A	
Typical Recharge Time		8 hours Recover to 90% Capacity	
<b>ALARMS</b>			
Utility Failure		Beep / 4sec	
Low Battery		Beep / 1sec	
Overload		Beep Twice / 1sec	
UPS Fault		Long Beep	
<b>ENVIRONMENTAL</b>			
Humidity		20-90% RH @ 0-40°C (Non-Condensing)	
Noise Level		≤50 dB (1m)	
<b>COMMUNICATION</b>			
RS232 (Standard) / USB (Optional)		Supports Windows®98/2000/2003/XP/Vista/2008/Windows®7/8/10	
SNMP (Optional)		Power Management from SNMP Manager and Web Browser	
<b>DIMENSIONS &amp; WEIGHT</b>			
Dimensions WxDxH (mm)		262 x 650 x 735	
Packaging Dimensions WxDxH (mm)		440 x 720 x 940	
Net Weight (kg)		64.1	70.8
Gross Weight (kg)		72.2	78.9

Makelsan reserves the right to change or modify product design, construction, specifications, or materials without prior notice and without incurring any obligation to make such changes and modifications on Makelsan products previously or subsequently sold. Makelsan does not guarantee the items of the accuracy and completeness.